

**NOTES:**

1. FACING TO CONSIST OF PREFABRICATED WWF 4" x 4" - W4.0 x W4.0 FORMS.
2. ALL FORMS AND STRUTS WILL BE FABRICATED WITH BLACK WIRE.
3. OVERALL LENGTH OF WIRE FORMS IS 10'-0". EFFECTIVE CONSTRUCTED WIDTH IS 9'-8" WITH 4" OVER LAPPING AT ENDS.

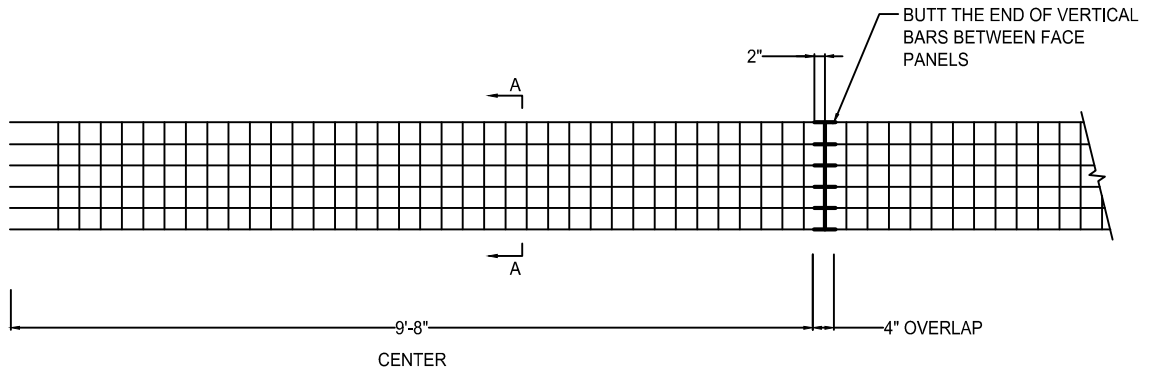

**WELDED WIRE FORM FACING UNIT**

NOT TO SCALE

**SIERRA® SLOPE RETENTION SYSTEM**

MKD-WW-GE-FC-001.DWG